

This design for Del Norte County shows how enterprise clusters can organize a facility and work cooperatively. The county later used another site for which Urban Ore also designed clusters.

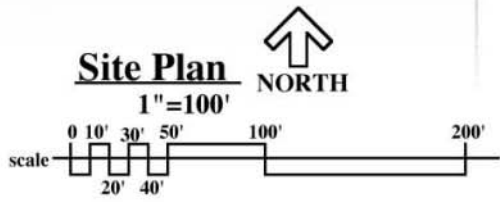

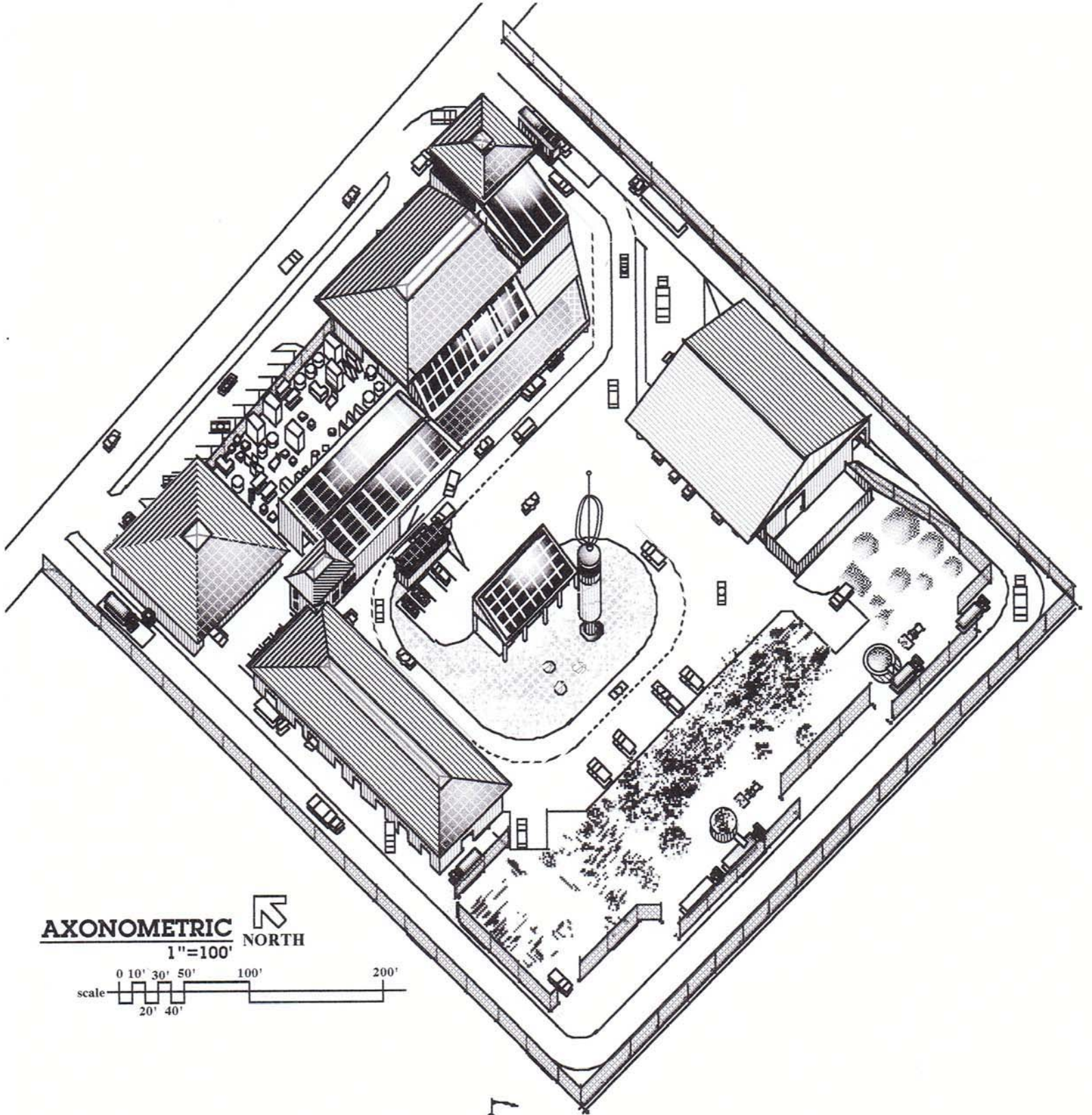

NORTH ELEVATION
1"=100'

**Del Norte Solid Waste Management Authority
Materials Recovery/Transfer Station
Site Plan • Phase III • 17 March 2001**

Urban Ore Design Group • Berkeley, California • Mark Gorrell, Architect